

Step 3 – Set up Home app

1. Download the Xplor Home App  via the [App Store](#) or [Google Play Store](#).
2. Enter the email address and password you have set up to log in.

To sign children in to DBOOSH (mornings)

1. Click “Sign In”

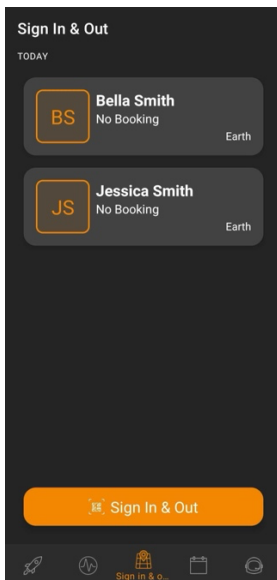

2. Click “Scan Code”

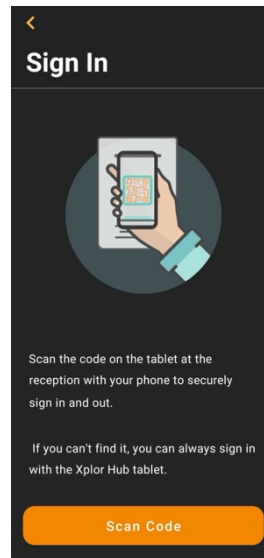

3. Click “Give Permission”

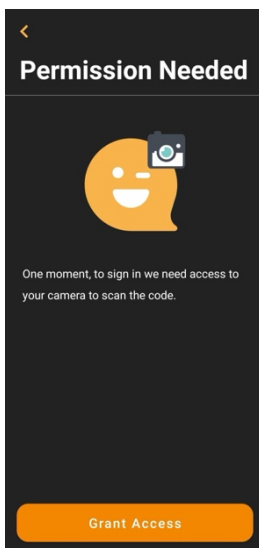

4. Scan the QR located on the “Hub” at DBOOSH

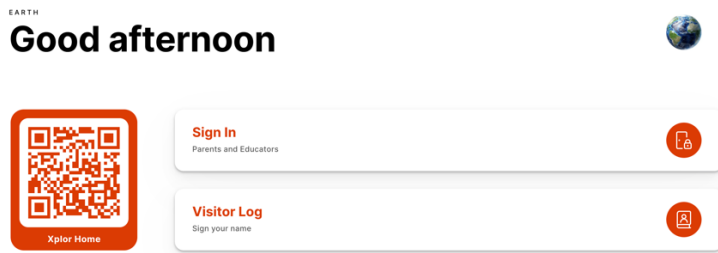

5. Click “Sign In”

Select the child/ren you need to sign in

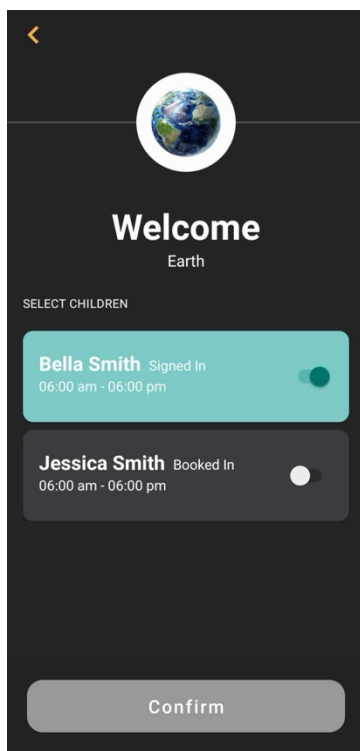

Click “Confirm”

Done!

To sign children out of DBOOSH (afternoons)

This is the same process as signing in, but select sign out at step 5.

To Invite a Hub guest (another carer who will sign your child/ren in or out)

1. Click the “Account” tab

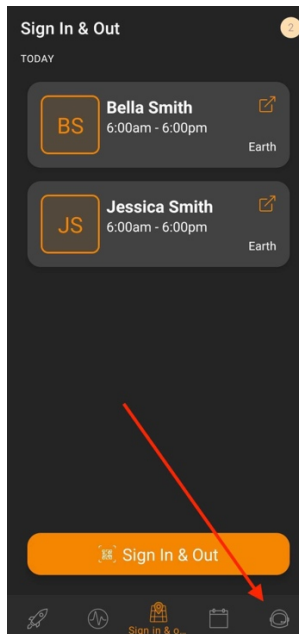

2. Click “Hub Guests”

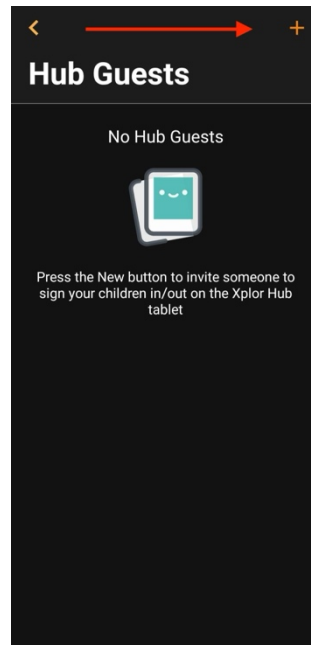

3. Enter the email address, first name, and last name of your chosen Hub Guest

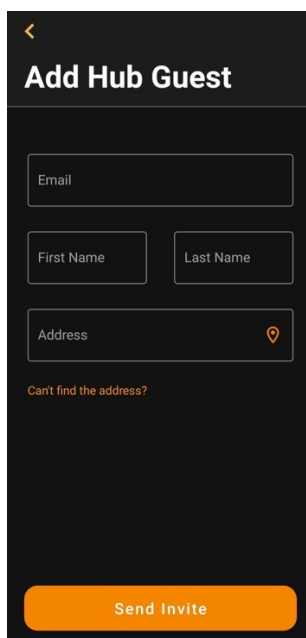
A screenshot of a mobile application interface titled "Add Hub Guest". It features four input fields: "Email", "First Name", "Last Name", and "Address". The "Address" field has a location pin icon. Below the "Address" field, there is a small text link that says "Can't find the address?". At the bottom, there is a large orange button labeled "Send Invite".

4. Click “Send Invite”